

Quick start guide

Vedolux 350/450/650

Detach the boiler from
the pallet:

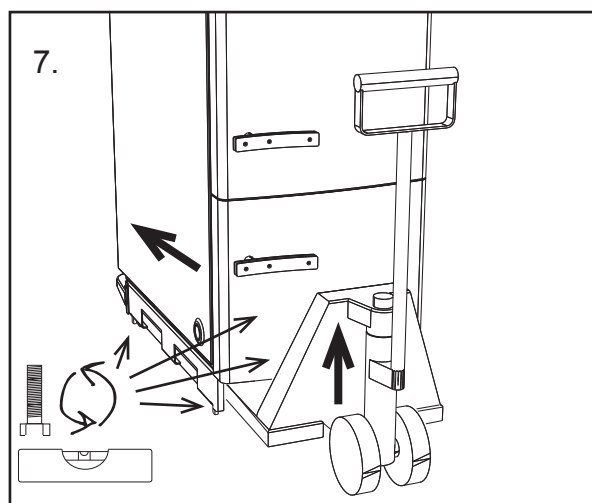
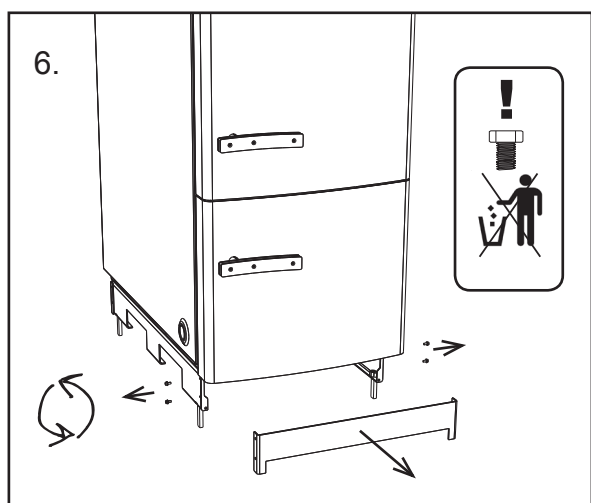
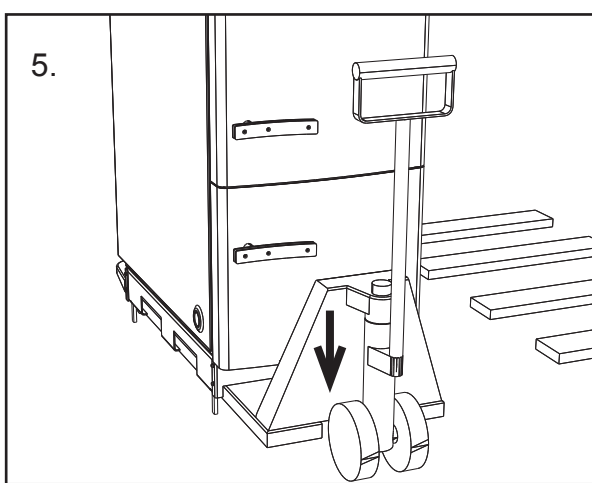
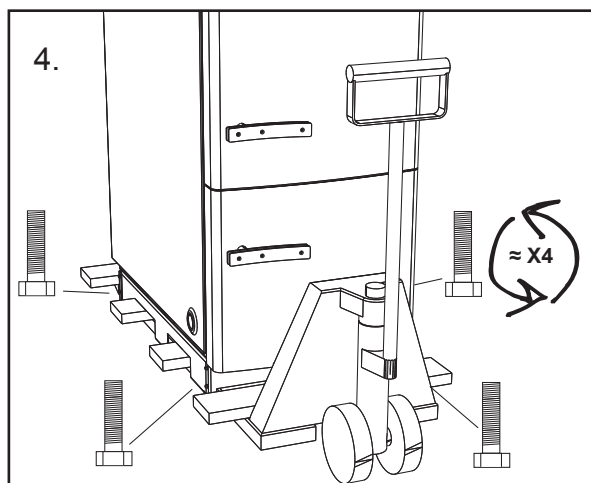
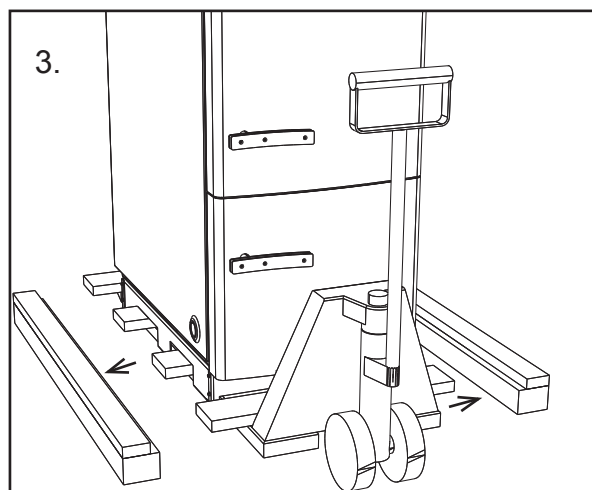
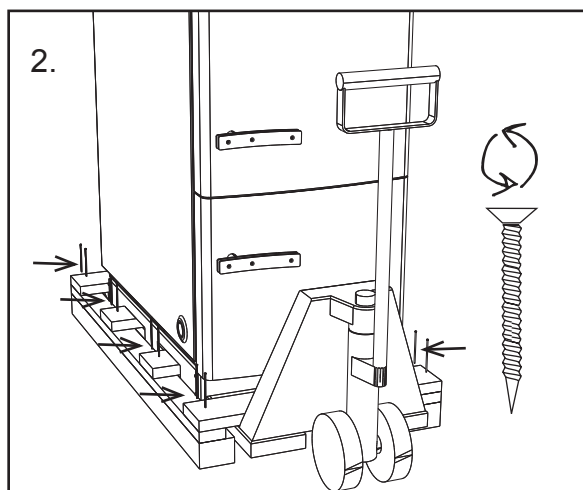
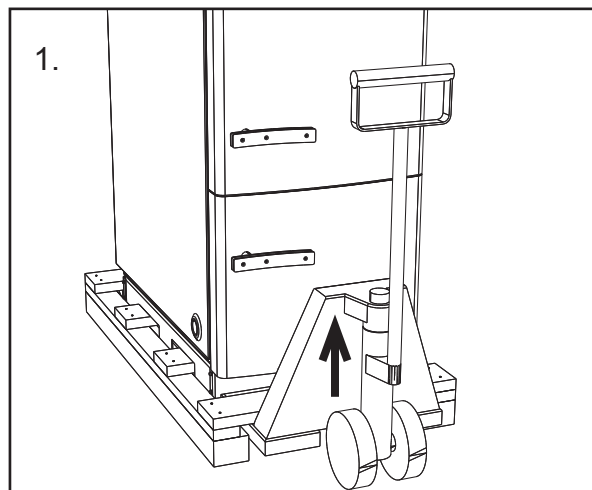
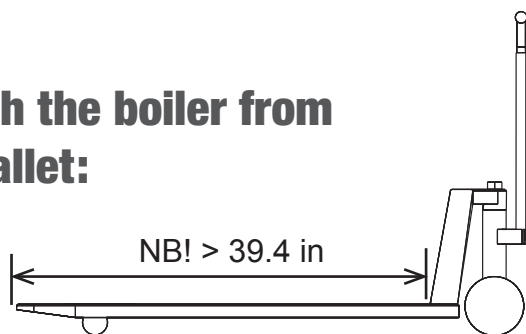

Position the boiler, minimum distance

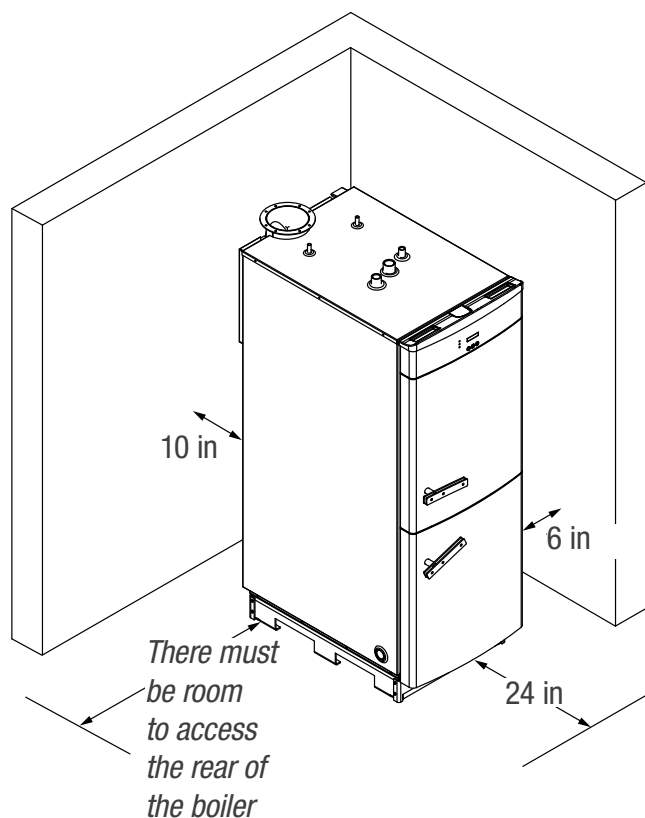

System in principle

This is a system in principle. The actual system must be installed according to existing rules and the instructions provided by each manufacturer for its product.

- a. Vedolux
- b. Accumulator system
- c. Hot tap water
- d. Heating circuit
- e. Safety valve
- f. Manometer
- g. Open expansion tank
- h. Thermal valve, STW
- i. Closed expansion tank
- j. Accumulator control

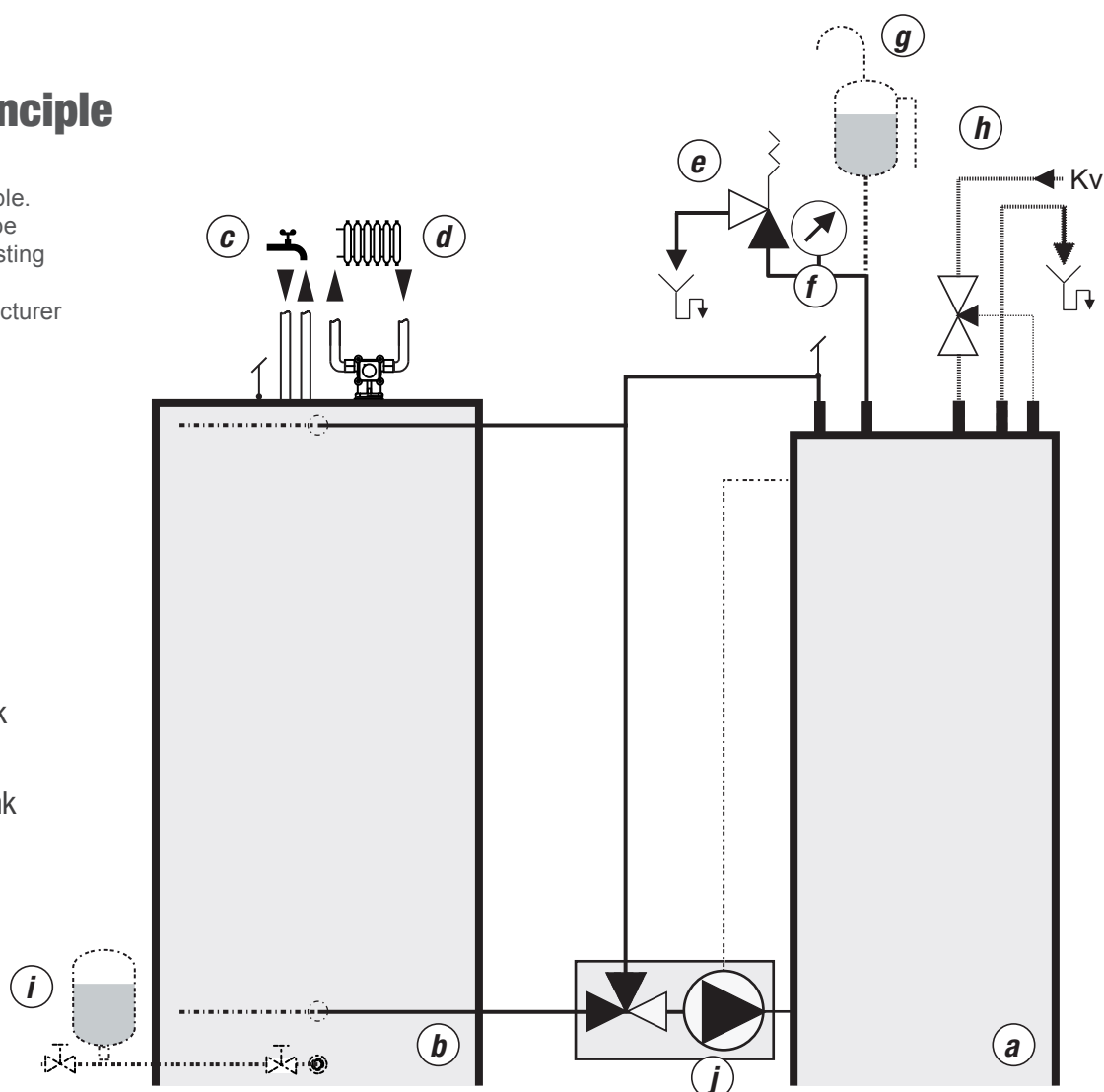

Electrical installation

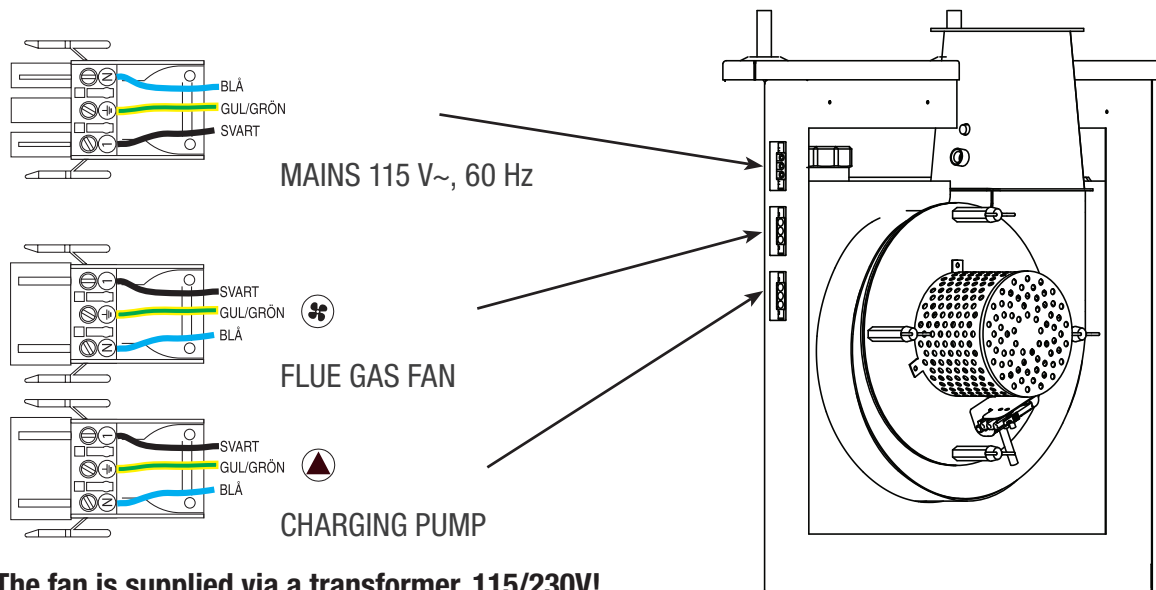

The fan is supplied via a transformer, 115/230V!

Fill the system with water

Ensure that all couplings and everything else are correctly installed. While the system is being filled with water, the installation can proceed with the ash drawer and flue pipe, among other things.

Flue pipe installation

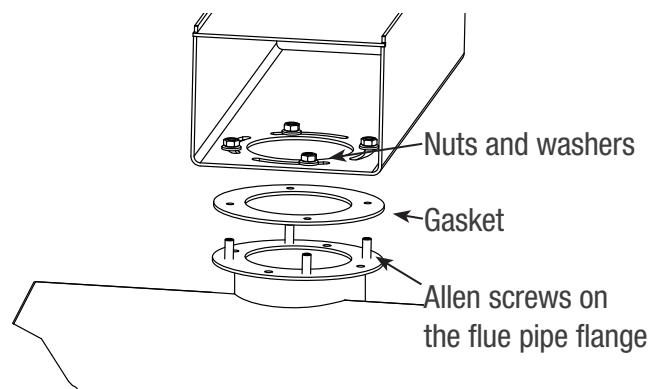

Install the ash drawer in the leg frame

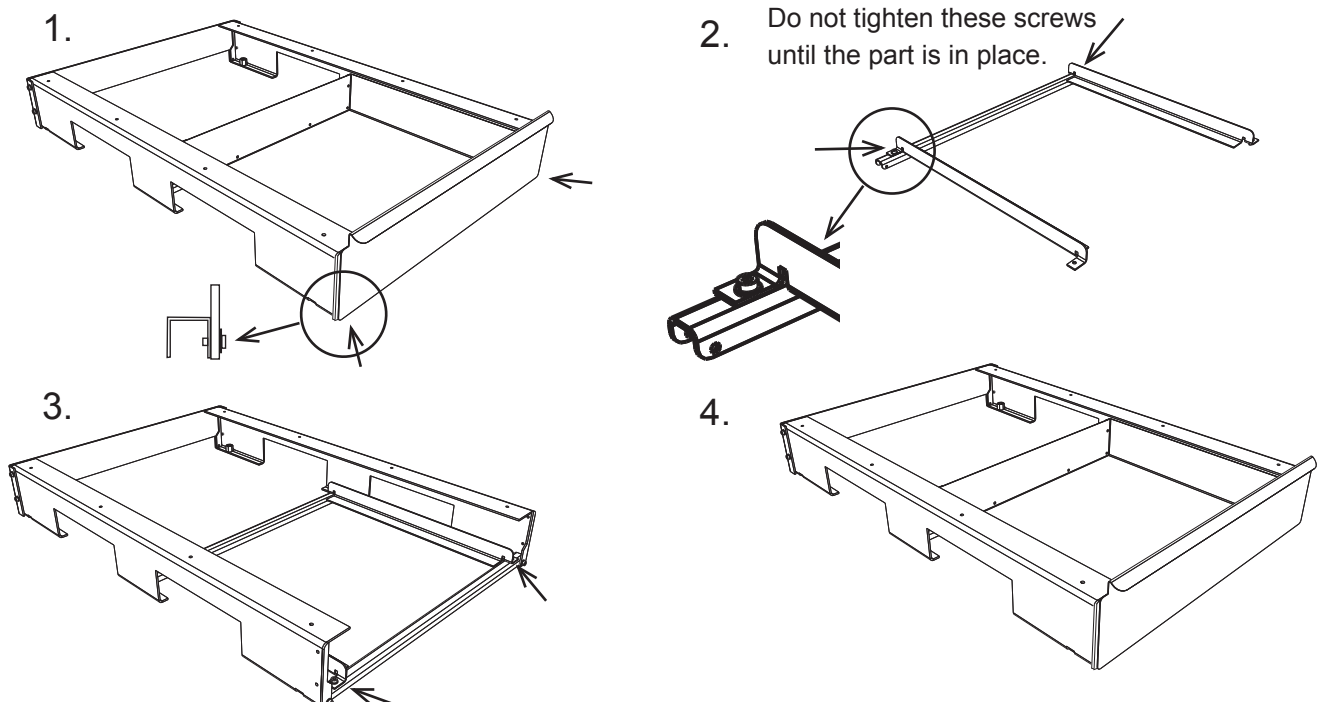

Commissioning

See the following sections in the 'Installation & Maintenance' guide and do as instructed:

- Control panel
- Aggregate test
- First firing
- Firing - Operation

Please note that this is a 'quick start guide'. More detailed descriptions are provided in 'Installation & Maintenance'.

Information for the user

Give the user information and instruction as described in the section 'FOR THE USER' in the guide.



Värmebaronen AB
Arkelstorpsvägen 88
SE-291 94 Kristianstad
Tel. +46 44 22 63 20
Fax +46 44 22 63 58
www.varmebaronen.se
www.varmebaronen.com
info@varmebaronen.se