

# VEDOLUX

LAMBDA CONTROL WOOD-FIRED BOILERS

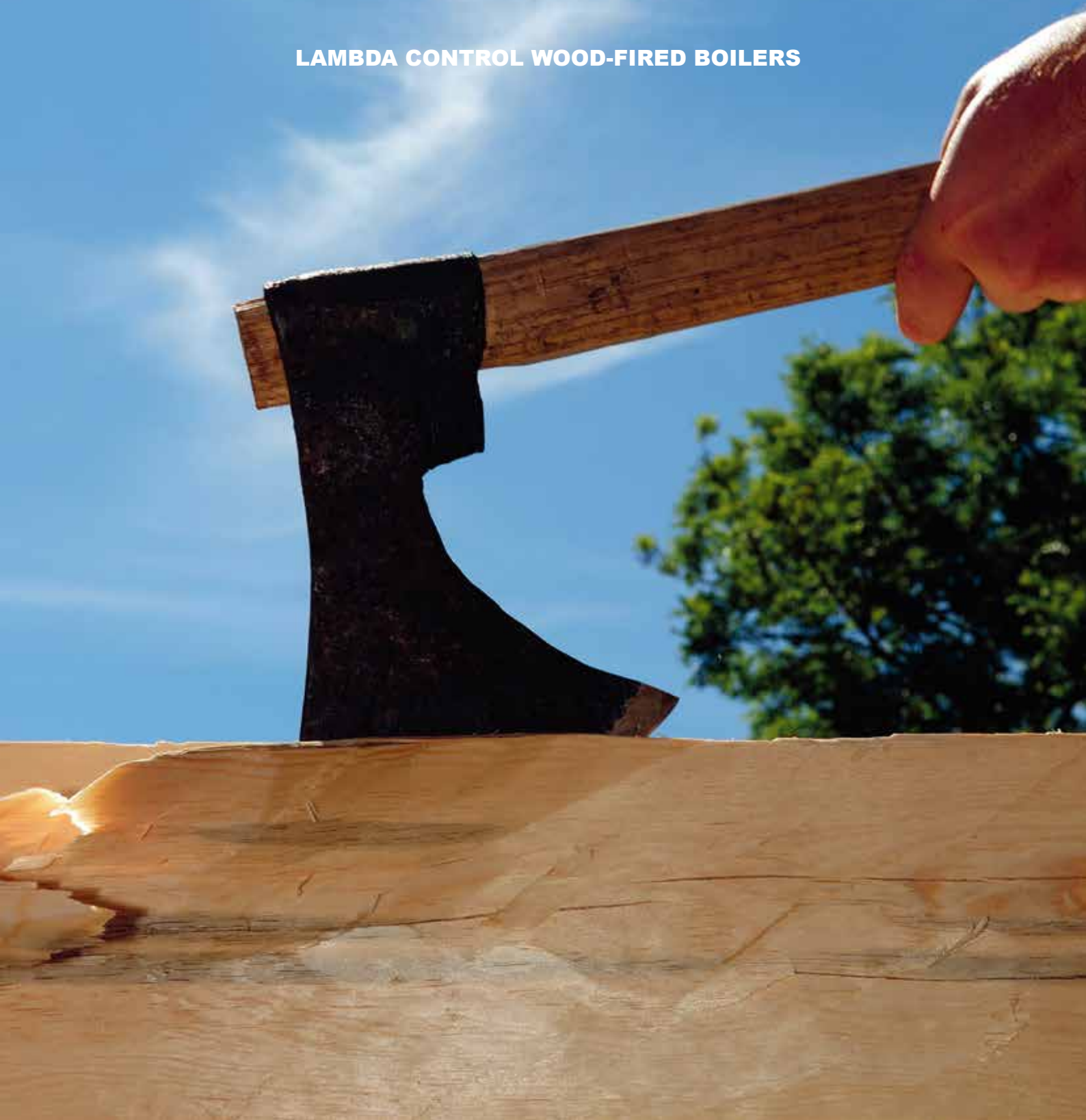







## WOOD BOILERS MADE WITH EXCELLENCE

Firing with wood is one of the lowest cost ways of heating your home. The Vedolux Lambda range makes it easier than ever.

Vedolux makes maintenance and handling easier for you. The clear display tells you what is going on in the boiler and guides you at the start. If you insert too much wood or poor quality wood, the boiler ensures that the output is adjusted so that the firing continues to be efficient and green. Hatch locks ensure that you cannot open the hatches by mistake.

Lambda control ensures that the wood lasts as long as possible and minimum soot created. This saves you work both on the wood and on boiler maintenance. Sweeping and ignition are simple, and take just a few minutes.

These boilers are very robust. The thick cover plates, solid buttons and handles are very durable and capable of a long time of service.

All the products in the catalogue are designed and made the Varmebaronen factory in Sweden.





# LAMBDA



## FOR THE FUTURE AND FOR THE ENVIRONMENT

Vedolux 350, 450 and 650 all have Lambda control. The principle is the same as in modern cars. The car's fuel economy and exhaust gas purification efficiency depend on the lambda value. Tests at SP, the Technical Research Institute of Sweden, show that both the efficiency and environmental values of Vedolux boilers are in a class of their own and the boilers thus meet strict emission requirements.

## LAMBDA ALSO SAVES TIME AND WORK

Lambda has the pleasant side-effect of saving you a lot of work. The high efficiency level of 93%\* ensures that you get as much heat as possible out of your wood. This means less time chopping wood and more time for leisure activities. It also means longer intervals between firings. The fact that the boilers are very easy to sweep saves you further time and work.





**“SWEDISH DESIGN SUCCESS”**

VVS-Forum no. 4 2011



# ROBUST

Its timeless design has gained the Vedolux range a great deal of attention at plumbing and heating fairs worldwide. But the Vedolux is not just a delight for the eye. Tests at SP, the Technical Research Institute of Sweden, show that both the efficiency and environmental values of Vedolux boilers are in a class of their own.

The unique design of the Vedolux means that it suits both confirmed wood firers and those who are looking for the best modern wood-fired boiler on the market.

The design and construction of the boilers produce unparalleled efficiency and ensure that the wood lasts a long time and the intervals between firings are long. Vedolux is a genuine quality product in all respects: steel quality, control, service and support.

"Värmebaronen's wood-fired boiler Vedolux has attracted attention and was permitted to represent Good Swedish Design"

VVS-Forum no. 4 2011  
ISH fair, Frankfurt

EFFICIENCY:

**93% \***

## QUALITY DOWN TO THE SMALLEST DETAIL



Handle



Grate



Display



Tested by SP

A number of other boilers are available in addition to the Vedolux Lambda. Värmebaronen has a wide range. Order our wood-firing catalogue.

\* tested with European standards using LHV for firewood fuel



"The Vedolux 650 resembles an exclusive retro-style fridge painted matt black. This colour should, by definition, be the optimum colour for a wood-fired boiler"

VVS-Forum no. 4 2011



## **CORRECT SIZING DELIVERS THE BEST ECONOMY**

Firing with wood is one of the lowest cost ways to heat and if you choose a boiler with the highest efficiency, it will save even more. Therefore, we have developed several Vedolux models with different output levels. This makes it easy to choose the right boiler for the right house. Vedolux lambda is available in outputs from 35 kW up to 65 kW.

- Top-class efficiency and environmental values, CO only 130 mg/m<sup>3</sup>.
- Easy maintenance makes it easy to maintain the high efficiency.
- A timeless, elegant design and robust finish in high-quality steel.
- Output reduction if too much wood is inserted gives you a wide margin of error, while the environmental requirements are still met.
- The service-friendly, carefully considered design means low service costs.



### **Sweep and ignite the boiler in five minutes:**

All sweeping takes place from the front through just one hatch. The round flues have no hidden corners or folds in which ash and soot can collect.

You can easily withdraw the turbulators from the boiler by hand. No tools are required. The soot collects in the base of the boiler and is simply raked out in the retractable ash drawer.

Insert the wood through the well-sized hatch and then light it with the LPG ignition supplied.

**It could not be easier.**



Vedolux with Aqualux Teknik accumulators

# AQUALUX

## CHOOSING THE RIGHT ACCUMULATOR TANK

By choosing a Vedolux wood-fired boiler, you are making an excellent choice. The appearance, ease of use and efficiency separate it from the competition. It is also important to make a good choice when you choose the accumulator water storage tank.

## AQUALUX TEKNIK ACCUMULATORS

Aqualux Teknik is the best choice if you are thinking of combining your wood firing with solar panels now or in the future. Aqualux Teknik tanks offer superior stratification-retaining properties compared to a standard tank. The buffer capacity is 15-20% higher than a good coil tank. Thanks to unique functions such as diffusers, Aqualux Teknik maintains its position as the leading accumulator on the market. Three different sizes to choose from.

Order our catalogue on combining heating. It contains all the information you need to read to understand how important it is to choose a really good accumulator tank.







## ABOUT WOOD

Wood firing need not be any more difficult than you make it. Some people like to collect their own wood and enjoy spending time in the forest. Others get together with neighbours and use machinery. This makes the job really fast and easy.

If you want to make things even easier for yourself, you can buy split wood. Whichever approach you take, wood firing is one of the most economical ways to heat your house.



Ready-split wood

## ABOUT SOLAR

Solar panels have become popular. Then there is no need to fire your boiler throughout the warm half of the year. The sun takes care of your hot water from April to September. Order our catalogue!



K2 solar panel

 **K2**  
SOLFÄNGARSYSTEM

# Vedolux 350 RSK 622 20 03

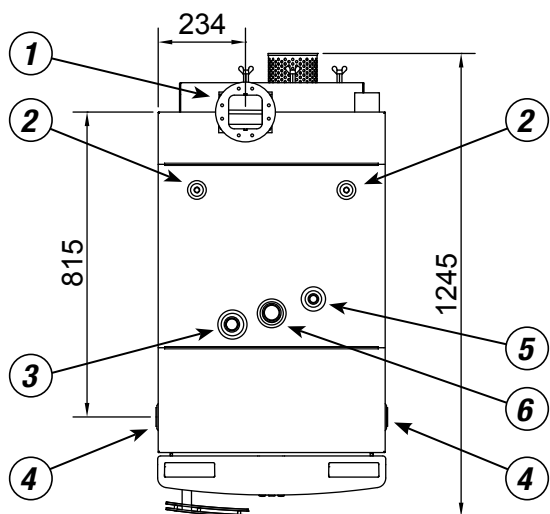
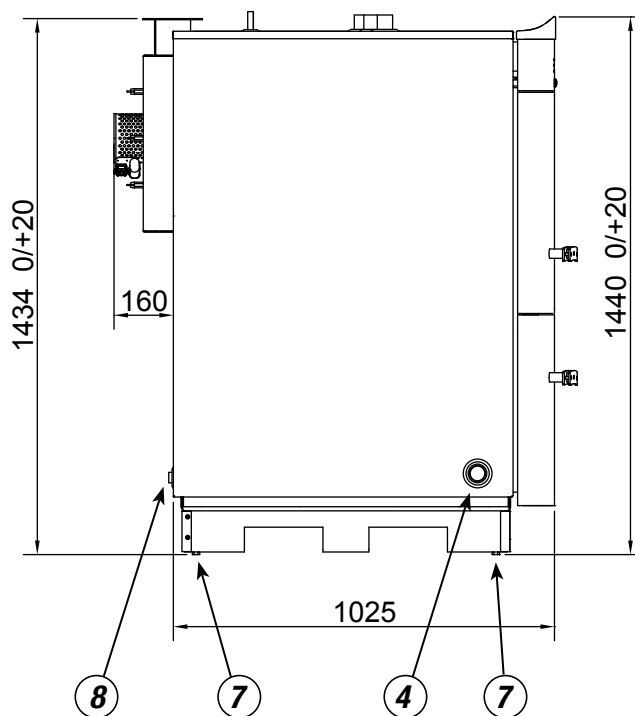
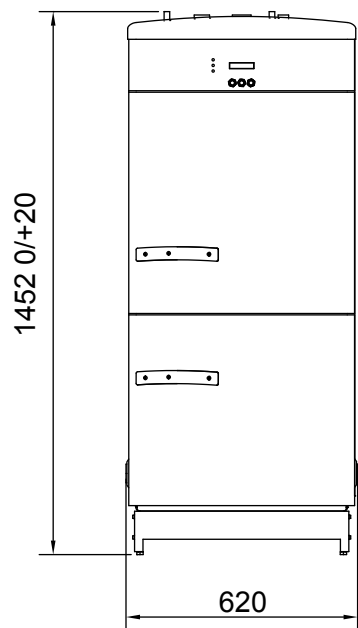

**Minimum distance between rear of boiler and wall is 250 mm.**

## Flue pipe

Standard

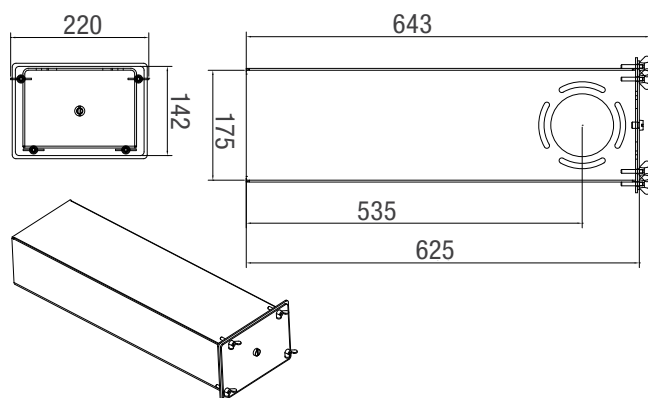

Flue pipe upwards, accessory

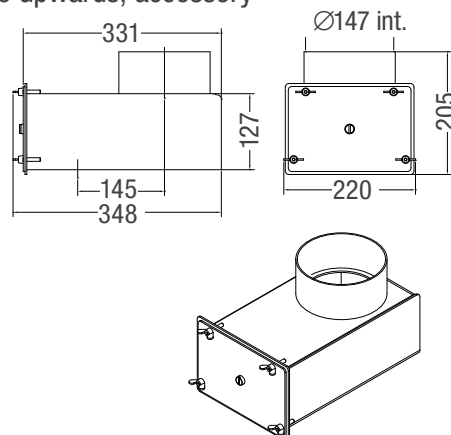



# Overview

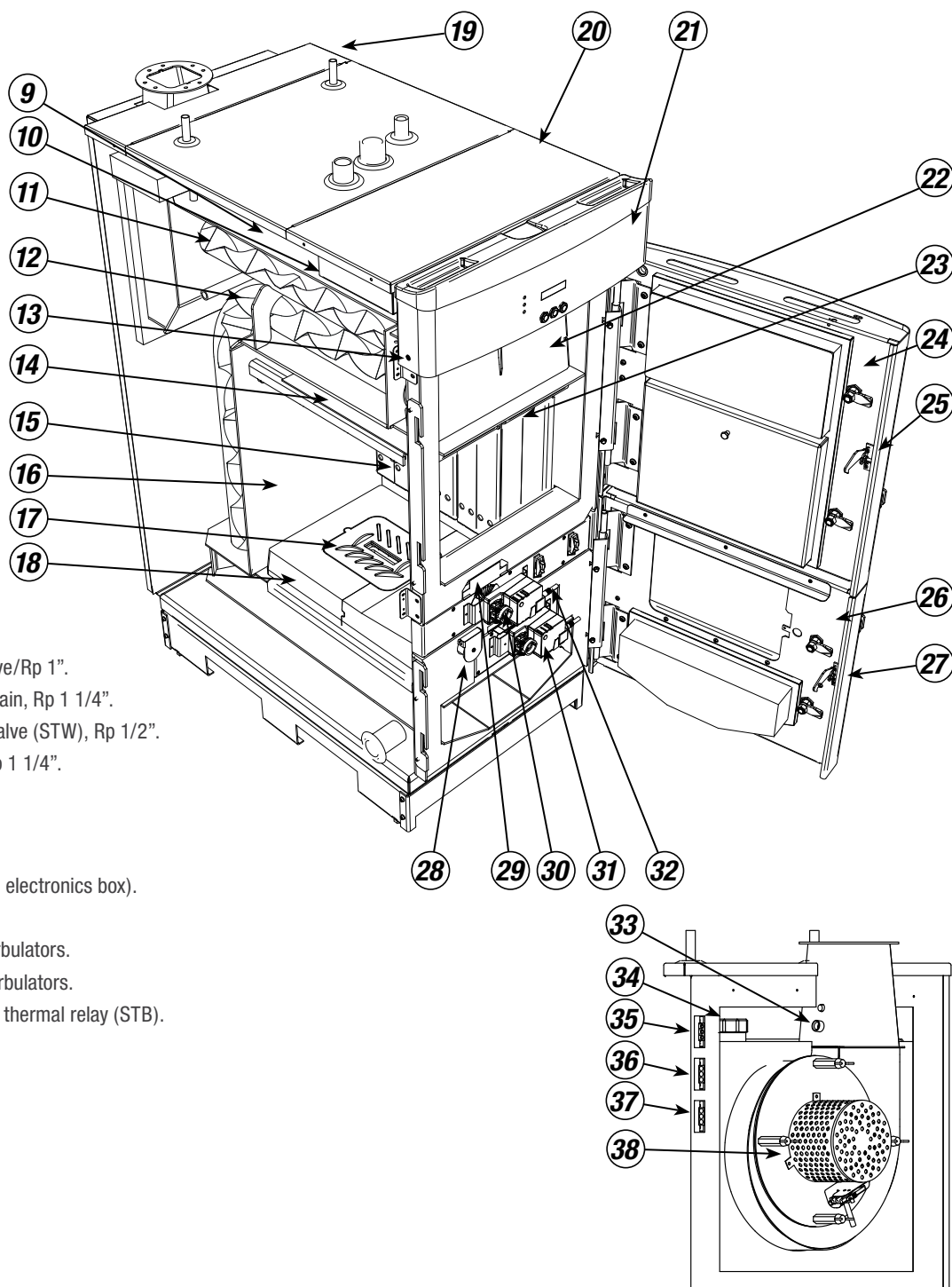

1. Flue pipe connection.
2. Cooling coil, DN 15.
3. Expansion connection/safety valve/Rp 1".
4. Return from accumulator tank/drain, Rp 1 1/4".
5. Connection, sensor for thermal valve (STW), Rp 1/2".
6. Flow line to accumulator tank, Rp 1 1/4".  
Can be used as lifting sleeve.
7. Adjustable foot bolts.
8. Drain, Rp 1/2".
9. Boiler temperature sensor (inside electronics box).
10. Box with boiler's electronics.
11. Upper flue gas tubes, 4, with turbulators.
12. Lower flue gas tubes, 4, with turbulators.
13. Resetting the max. temperature thermal relay (STB).
14. Bypass plate.
15. Air plates, detachable.
16. Wood store.
17. Grate.
18. Ceramics.
19. Rear cover plate, detachable.
20. Front cover plate, detachable.
21. Display/control panel.
22. Soot hatch.
23. Bypass damper.
24. Wood filling/soot hatch.
25. Latch, wood filling hatch.
26. Ash hatch.
27. Latch, ash hatch.
28. Opening for LPG ignition.
29. Back-pressure damper, primary.
30. Motor/damper, primary air.
31. Motor/damper, secondary air.
32. Back-pressure damper, secondary.
33. Flue gas temperature sensor.
34. O2 probe.
35. Mains connection, 115 V~.
36. Supply, 115 V~, flue gas fan.
37. Supply, 115 V~, charging pump.
38. Fan.

Weight	empty	478 kg
	full of water	620 kg
Water volume		140 litre
Fuel: Wood	length	500 mm
Wood store	volume	100 litre
	depth	550 mm
Filling hatch	w x h	350 x 265 mm
Power	nominal	35.8 kW
Chimney requirements	height	≥5 m
	draught	-0.15 mbar
	diameter	150 mm
Accumulator volume	min.	1500 litre

# Vedolux 450 RSK 622 20 04

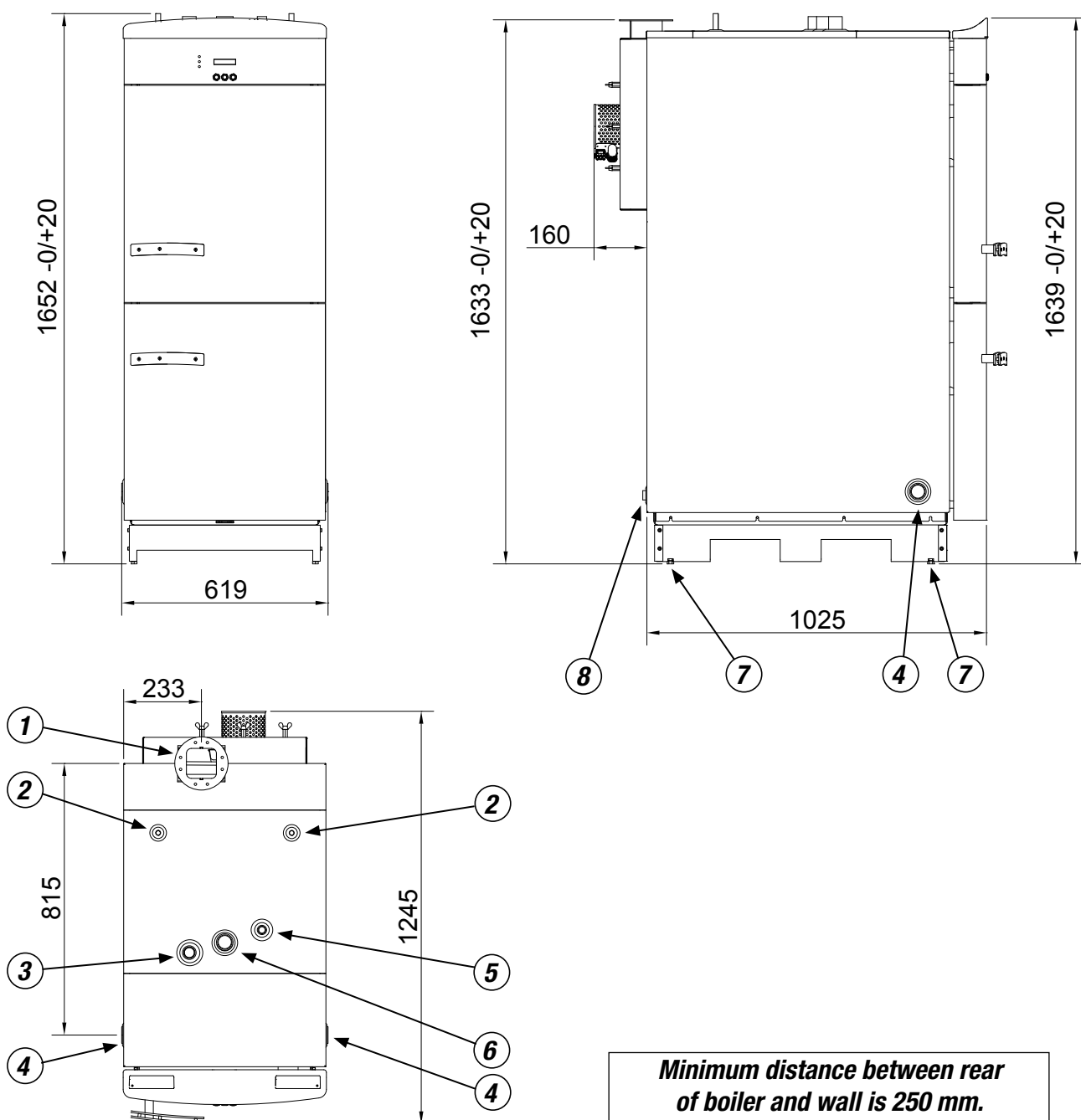

## Flue pipe

Standard

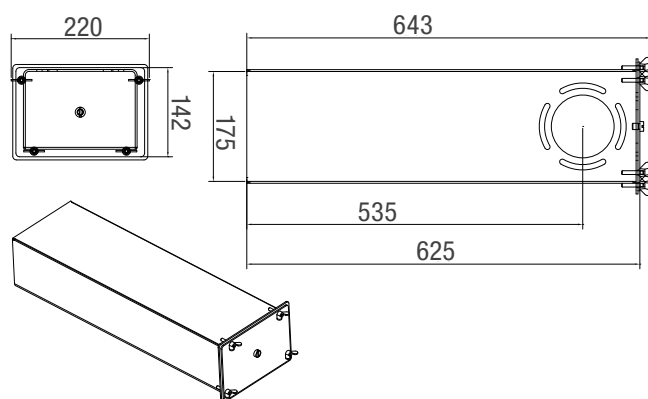

Flue pipe upwards, accessory

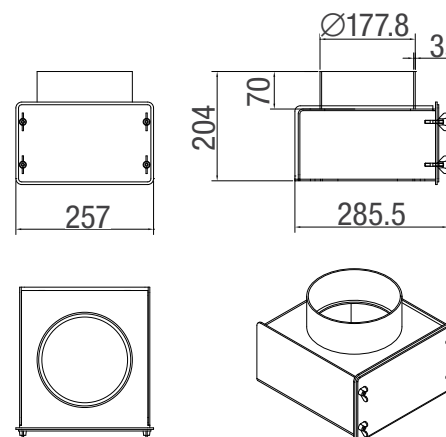

# Overview

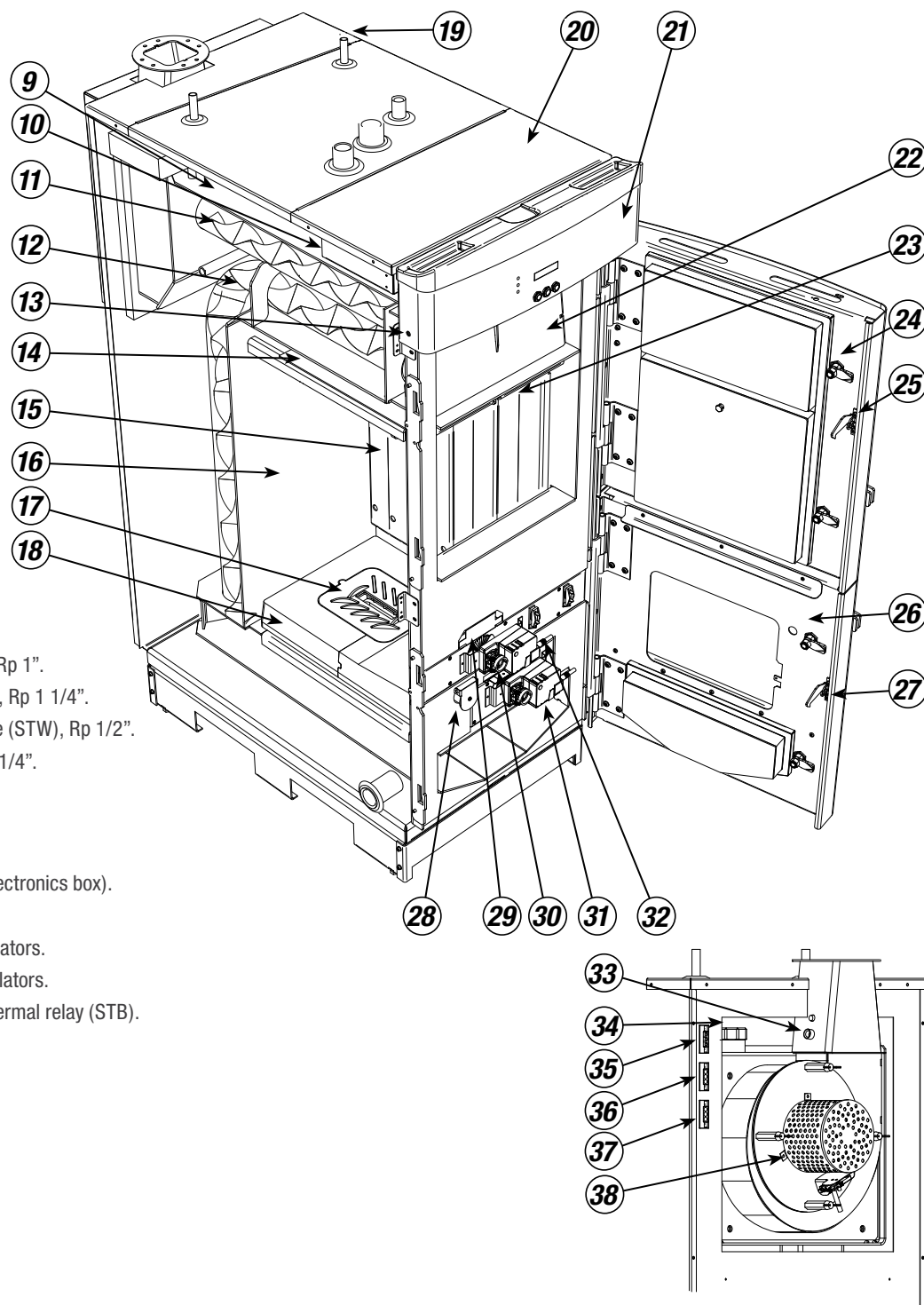

1. Flue pipe connection.
2. Cooling coil, DN 15.
3. Expansion connection/safety valve/Rp 1".
4. Return from accumulator tank/drain, Rp 1 1/4".
5. Connection, sensor for thermal valve (STW), Rp 1/2".
6. Flow line to accumulator tank, Rp 1 1/4".  
Can be used as lifting sleeve.
7. Adjustable foot bolts.
8. Drain, Rp 1/2".
9. Boiler temperature sensor (inside electronics box).
10. Box with boiler's electronics.
11. Upper flue gas tubes, 4, with turbulators.
12. Lower flue gas tubes, 4, with turbulators.
13. Resetting the max. temperature thermal relay (STB).
14. Bypass plate.
15. Air plates, detachable.
16. Wood store.
17. Grate.
18. Ceramics.
19. Rear cover plate, detachable.
20. Front cover plate, detachable.
21. Display/control panel.
22. Soot hatch.
23. Bypass damper.
24. Wood filling/soot hatch.
25. Latch, wood filling hatch.
26. Ash hatch.
27. Latch, ash hatch.
28. Opening for LPG ignition.
29. Back-pressure damper, primary.
30. Motor/damper, primary air.
31. Motor/damper, secondary air.
32. Back-pressure damper, secondary.
33. Flue gas temperature sensor.
34. O2 probe.
35. Mains connection, 115 V~.
36. Supply, 115 V~, flue gas fan.
37. Supply, 115 V~, charging pump.
38. Fan.

Weight	empty	560 kg
	full of water	730 kg
Water volume		170 litre
Fuel: Wood	length	500 mm
Wood store	volume	140 litre
	depth	550 mm
Filling hatch	w x h	350 x 325 mm
Power	nominal	47 kW
Chimney requirements	height	≥5 m
	draught	-0.15 mbar
	diameter	150 mm
Accumulator volume	min.	3000 litre



# Vedolux 650 RSK 622 20 05

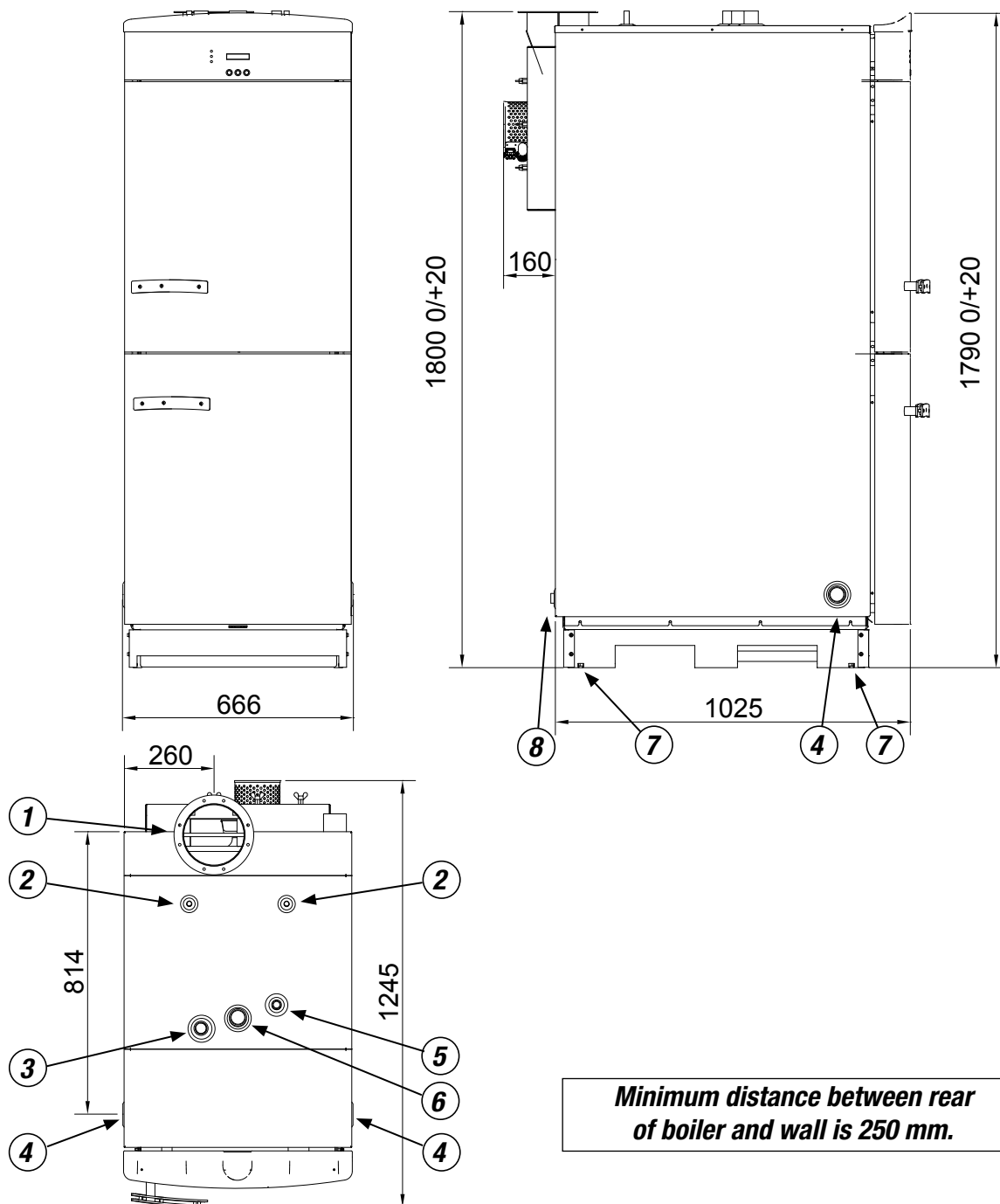

**Minimum distance between rear of boiler and wall is 250 mm.**

## Flue pipe

Standard

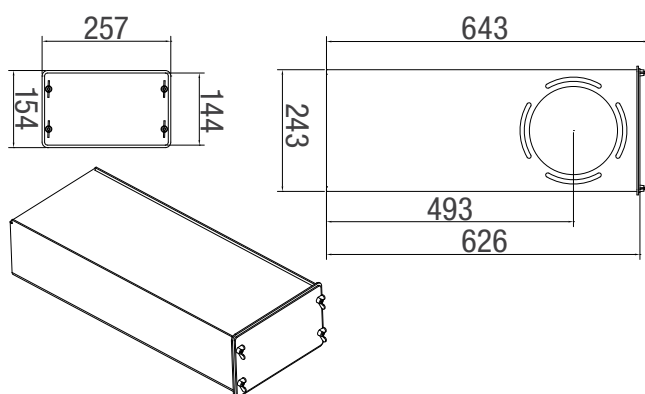

Flue pipe upwards, accessory

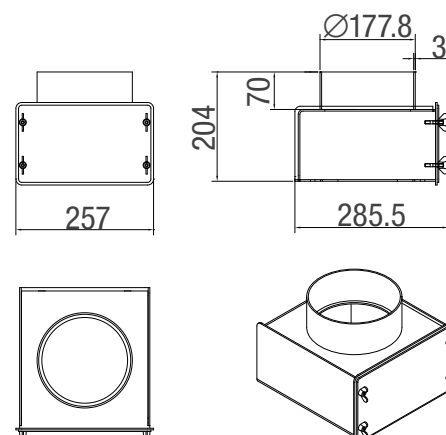

# Overview

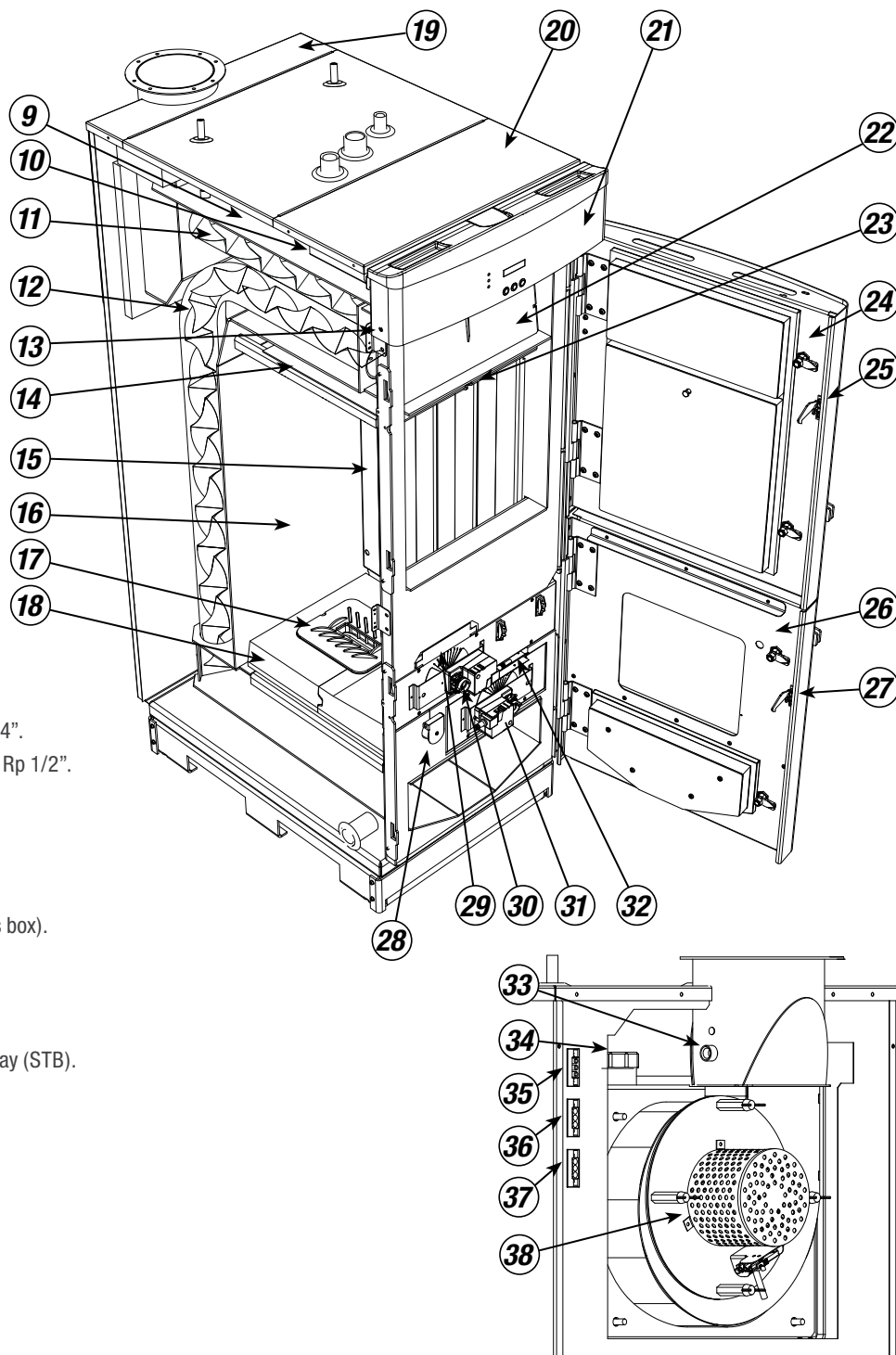

1. Flue pipe connection.
2. Cooling coil, DN 15.
3. Expansion connection/safety valve/Rp 1".
4. Return from accumulator tank/drain, Rp 1 1/4".
5. Connection, sensor for thermal valve (STW), Rp 1/2".
6. Flow line to accumulator tank, Rp 1 1/4".  
Can be used as lifting sleeve.
7. Adjustable foot bolts.
8. Drain, Rp 1/2".
9. Boiler temperature sensor (inside electronics box).
10. Box with boiler's electronics.
11. Upper flue gas tubes, 4, with turbulators.
12. Lower flue gas tubes, 4, with turbulators.
13. Resetting the max. temperature thermal relay (STB).
14. Bypass plate.
15. Air plates, detachable.
16. Wood store.
17. Grate.
18. Ceramics.
19. Rear cover plate, detachable.
20. Front cover plate, detachable.
21. Display/control panel.
22. Soot hatch.
23. Bypass damper.
24. Wood filling/soot hatch.
25. Latch, wood filling hatch.
26. Ash hatch.
27. Latch, ash hatch.
28. Opening for LPG ignition.
29. Back-pressure damper, primary.
30. Motor/damper, primary air.
31. Motor/damper, secondary air.
32. Back-pressure damper, secondary.
33. Flue gas temperature sensor.
34. O2 probe.
35. Mains connection, 115 V~.
36. Supply, 115 V~, flue gas fan.
37. Supply, 115 V~, charging pump.
38. Fan.

Weight	empty	730 kg
	full of water	930 kg
Water volume		200 litre
Fuel: Wood	length	500 mm
Wood store	volume	200 litre
	depth	550 mm
Filling hatch	w x h	400 x 420 mm
Power	nominal	65 kW
Chimney requirements	height	≥5 m
	draught	-0.15 mbar
	diameter	180 mm
Accumulator volume	min.	3500 litre



Arkelstorpsvägen 88

SE-291 94 Kristianstad

email: [info@varmebaronen.se](mailto:info@varmebaronen.se)

[www.varmebaronen.com](http://www.varmebaronen.com)



### North America Contact Information

SmokeLess Heat LLC

USA Varmebaronen Distribution

2020 Cornwall Road

Lebanon, PA 17042

email: [info@smokelessheat.com](mailto:info@smokelessheat.com)

tollfree 855-389-0083

[www.SmokeLessHeat.com](http://www.SmokeLessHeat.com)

